

Specialized Application Solutions



Eliminate Headers above Window and Door Openings

Increases the Energy Envelope's efficiency by replacing the CFS Header with Insulation, which has four times the resistance to heat flow (LEED awards credits for framing efficiencies such as this).

Resolves framing challenges caused by specified headers such as:

- Different Depths Specified for Various Openings
- Special Order, Multi- Ply, Heavier Gauges Typically Needed to Carry Loads

Eliminates the Requirement for In-Line Framing

Typical steel framing requires studs, joists, and trusses to be in-line for the height of the building resulting in added additional time and materials.

Speeds Framing of Walls

- All cripples are the same length
- Eliminates the need for multiple jack studs
- Eliminates the material and the need to build and install the specified headers
- Eliminates two pieces of track the width of each opening

Speeds Framing of the Floors

- Use a clip or hanger for attachment versus track and stiffeners
- Easier Fastening
- Rim Beams can be Fabricated up to 30' in length requiring few splices.
- Eliminates the need for rim track
- Joists are not required to sit over studs



Environmental Data - The Average Recycled Steel Content of Metwood Products (% of Total Weight) is 70% or greater and are 100% recyclable.

METWOOD BUILDING SOLUTIONS

Specialized Application
Solutions

by Metwood

819 Naff Road.
Boones Mill, VA. 24065
Ph: 540-334-4294
Tf: 866METWOOD
Fx: 540-334-4293

www.metwood.com

Specialized Application Solutions

by Metwood

Specialized Application Solutions

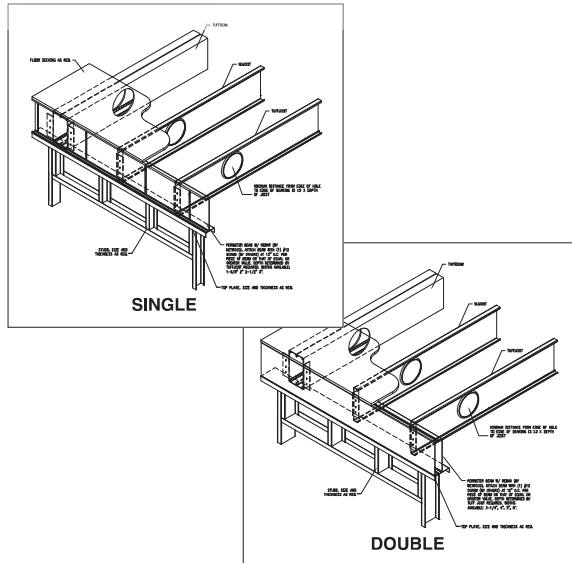

Remodel Beam



Concrete Columns and Bond Beam



Environmental Data - The Average Recycled Steel Content of Metwood Products (% of Total Weight) is 70% or greater and are 100% recyclable.

METWOOD

BUILDING SOLUTIONS

819 Naff Road. Boones Mill, VA. 24065
Ph: 540-334-4294 Tf: 866METWOOD Fx: 540-334-4293
www.metwood.com