

# TUFF FLOOR™ - The Complete Floor System



TUFF BEAM™, TUFF JOIST™, and TUFF JOIST+™ make up the TUFF Floor™ Systems, offering the design flexibility to achieve conventional or radical floor designs. Pre-punched reinforced access holes allow plumbing, HVAC, electrical, and other technology services to be installed within the floor system to improve ease of installation while maintaining structural integrity.

Joists can free span or utilize TUFF BEAM™ to eliminate vertical supports. Use TUFF FLOOR™ Ledger and Hanger System on ICF™ projects to reduce project cycle time.

- Design Flexibility
- Non-combustible
- Commercial and Residential
- Green Building Products
- Hangers and Ledger System
- Support Plywood, Concrete, or Other



**Environmental Data** - The Average Recycled Steel Content of Metwood Products (% of Total Weight) is 70% or greater and are 100% recyclable.

# METWOOD BUILDING SOLUTIONS

**TUFF FLOOR™**

The Complete Floor System

by Metwood

819 Naff Road.  
Boones Mill, VA. 24065  
Ph: 540-334-4294  
Tf: 866METWOOD  
Fx: 540-334-4293

[www.metwood.com](http://www.metwood.com)

## TUFF FLOOR™

The Complete Floor System

by Metwood

# TUFF FLOOR™ - The Complete Floor System

## Flooring Deck Options

- Metal
- Particle Board
- Plywood
- CBPB (Concrete Bonded Particle Board)
- EPS Panels
- SIPS (Structurally Insulated Panels) and more

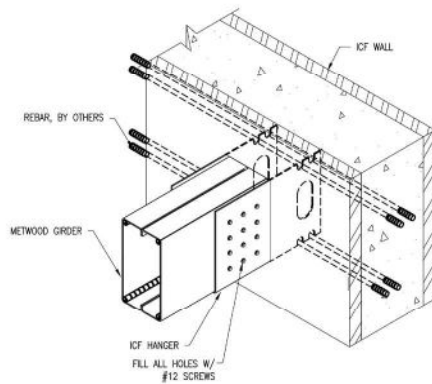

## ICF HANGER

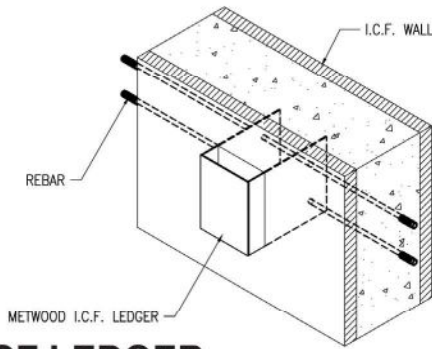

## ICF LEDGER

## Applications

- Complete Garages Solutions
- Messanines
- Living Space
- Roof Systems

## Simple Four Step Installation Process

1. Prepare Beam Pockets and Supports based on design
2. Install TUFF BEAM™, TUFF JOIST™, TUFF JOIST+™
3. Install Decking, Rebar, and In-floor Heating tube (as necessary)
4. Install Concrete Forms, Pour Concrete



# TNT™

FLOOR SYSTEMS

Insulated Framing System for  
Concrete Floors, Roofs, and Decks

